

# DRAINVAC®



## Commercial-Industrial Catalogue

International



FEB 2024

# UNITS WITH BRUSHES

## Series comparison:



### Cyclonik

- ✓ Vacuums dry and liquid materials
- ✓ Operates without any bag
- ✓ Suction power always constant
- ✓ Large-capacity canister



### ProXtrak

- ✓ Vacuums liquid materials only
- ✓ Automatically empties itself in the toilet or outdoors
- ✓ Operates without a bag, nor a filter
- ✓ Unit on wheels



### Automatik

- ✓ **Our signature series :** operates without a bag, filtered by water and empties itself automatically into the drain
- ✓ Vacuums dry and liquid materials
- ✓ Water source required



### Booster

- ✓ Upgrades an existing unit
- ✓ Increases the power of your system

# CYCLONIK

## Specific characteristics of this series:

- ✓ Vacuum both dry and liquid substances.
- ✓ Always maintains the same superior suction power.
- ✓ Cyclonic effect vacuum.
- ✓ No dust bag required.

### Outdoor exhaust required

This series works with a cyclonic filtration system. An outdoor exhaust will evacuate the microdusts, allergens and odours outside.

Carbon dust collector

WET

DRY

### Capacity up to 54 L

The largest canister we offer.

### Maximum Liquid Level

A sticker indicating the maximum liquid level recommended. Beyond this line, the canister gets very heavy when it comes time to empty it.



# AUTOMATIK

## Specific characteristics of this series:

- ✓ **Our signature series:** operates without a bag, nor a filter and automatically empties itself into the drain by electrodes.
- ✓ Vacuums both dry and liquid substances.
- ✓ Equipped with a membrane, a porthole and two water jets.
- ✓ Requires a water supply.

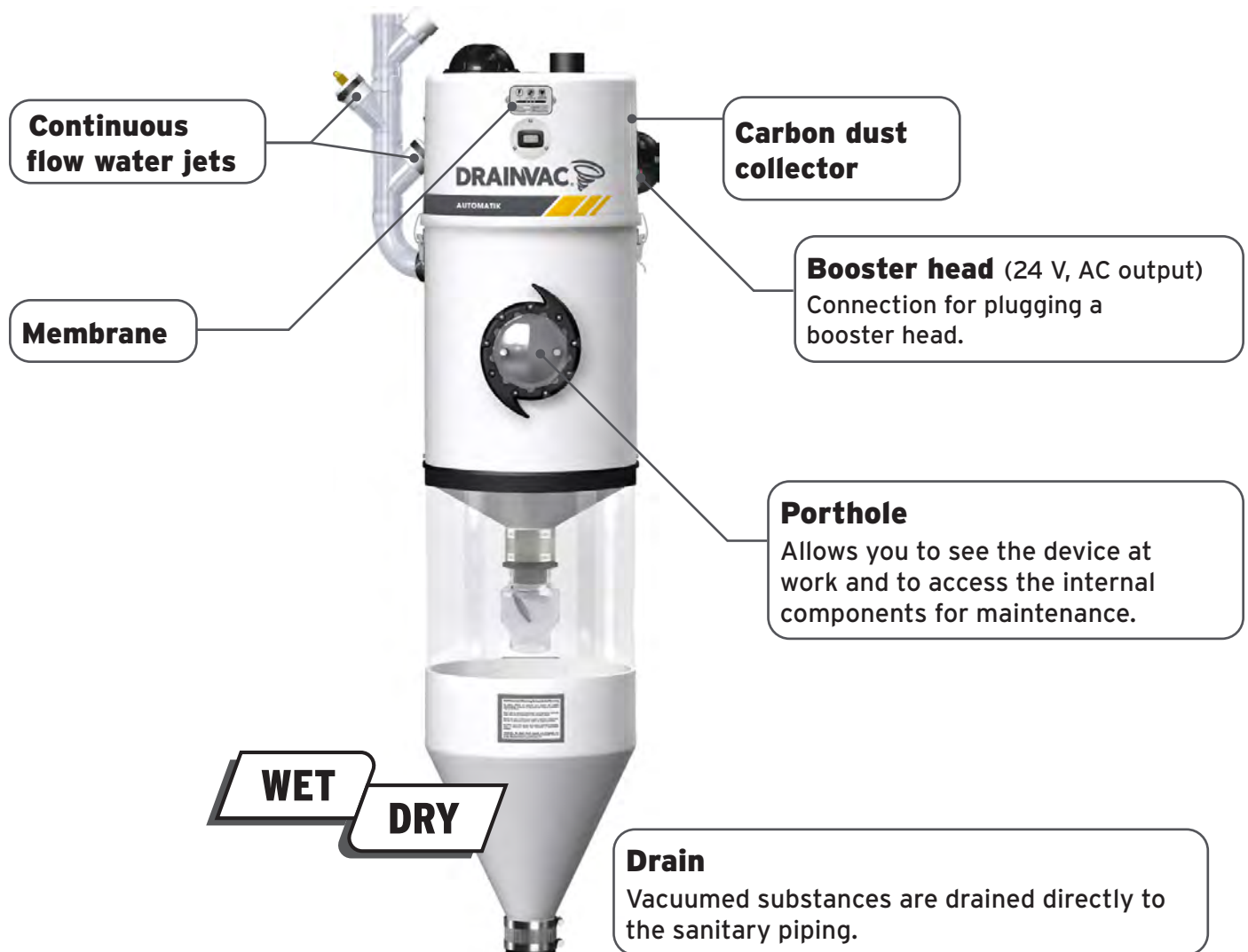

# AUTOMATIK

## Operation sequence:

Watch the video sequence!

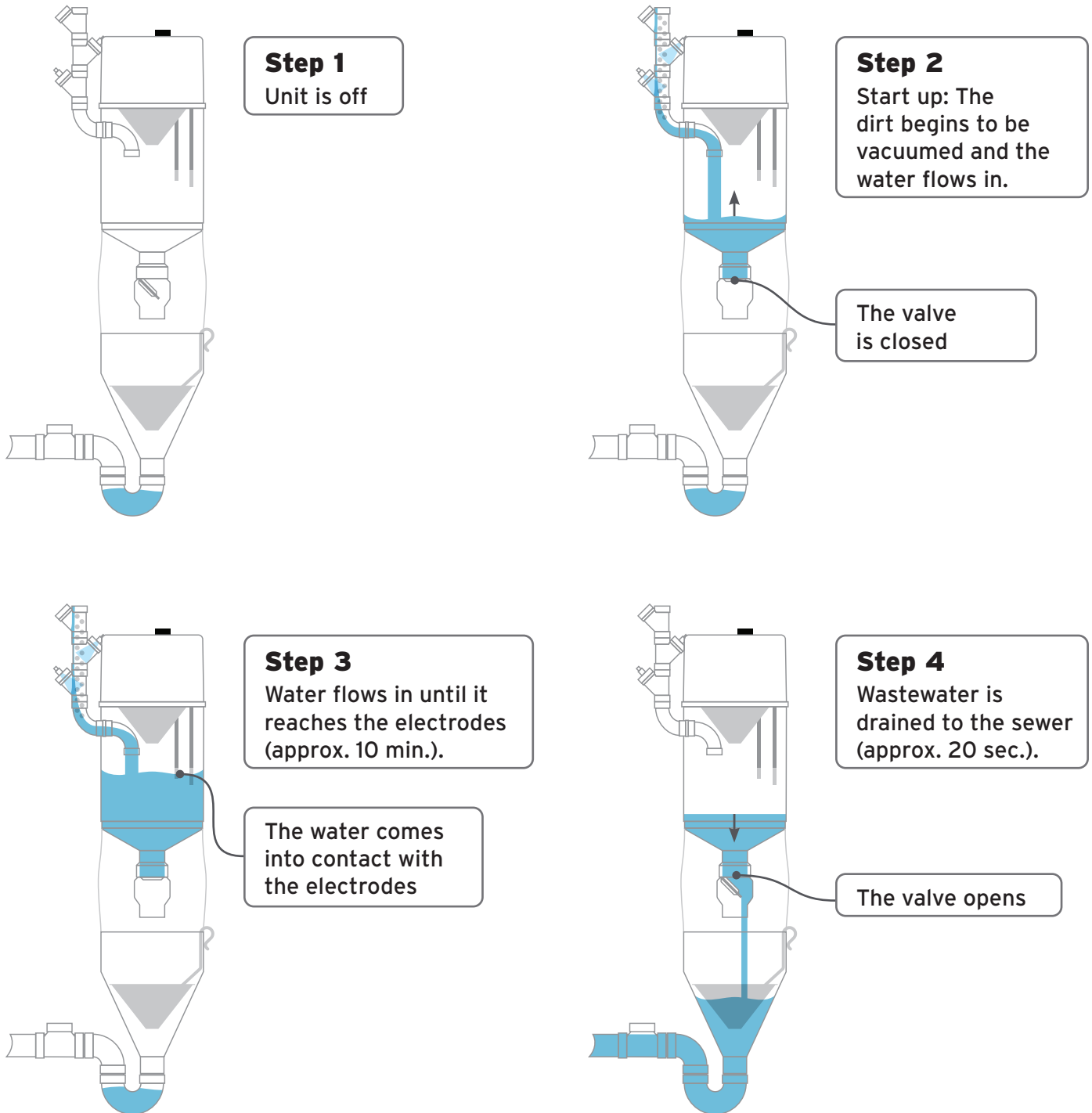

# AUTOMATIK

<b>MODEL</b>	<b>DF2A313-CB</b>
POWER	3.46 HP
WATERLIFT	4191 mmH <sub>2</sub> O
AIRFLOW	198 m <sup>3</sup> /h
NOISE LEVEL	70 dB
VOLTAGE	220V - 240V
WATTS	2592
FLOW RATE	2.3 L/min
HEIGHT	165 cm
DIAMETER	38 cm
CAPACITY	Up to 29 L
WEIGHT	29.5 kg
BREAKER	12 A
ELECTRICAL PANEL	16 A circuit breaker
CIRCUIT CODE	CIRC14R5INT

<b>MOTOR</b>	<b>MOTE14</b>
TYPE	Bypass
QUANTITY	2 in series
DIAMETER	14 cm
AMPS	10.8
CARBON BRUSHES	BROS28



Vacuums dust and liquids



Operates without a dust bag or a filter



Easy maintenance



Large capacity

## X Booster head not compatible

Please opt for the commercial model DF2A31-CB.

- ✓ Outdoor exhaust and water inlet required
- ✓ Includes 1 muffler
- ✓ Requires a water supply

## X Drain pipes not included

- ✓ Hour meter
- ✓ Lifetime warranty casing



All illustrations, specifications, colors and photographs shown may vary. The power values may vary. These are calculated according to the voltage used in the factory and in accordance to the supplier's technicalities. While Drainvac takes care to ensure that the information contained in this publication is accurate, it cannot guarantee complete accuracy. Drainvac is not responsible for errors or omissions contained in this publication.

# BOOSTER

## Specific characteristics of this series:

- ✓ Increases the power of a unit.
- ✓ Can be connected to increase flow rate or water column.

## Caution:

- ✓ Maximum of 2 Boosters per unit
- ✓ Can only be connected to commercial units.\*  
**\*Certain commercial models do not have the option to connect to an auxiliary head.**



A booster head can be installed in two ways; either in series or in parallel.

**A configuration in series**  
produces more water column.

**A configuration in parallel**  
produces more CFM..

