

DRAINVAC®

Commercial-Industrial Catalogue

International



DEC 2023



CYCLONIK

Specific characteristics of this series:

- ✓ Vacuum both dry and liquid substances.
- ✓ Always maintains the same superior suction power.
- ✓ Cyclonic effect vacuum.
- ✓ No dust bag required.

Outdoor exhaust required

This series works with a cyclonic filtration system. An outdoor exhaust will evacuate the microdusts, allergens and odours outside.

Carbon dust collector

WET

DRY

Capacity up to 54 L

The largest canister we offer.

Maximum Liquid Level

A sticker indicating the maximum liquid level recommended. Beyond this line, the canister gets very heavy when it comes time to empty it.



AUTOMATIK

Specific characteristics of this series:

- ✓ **Our signature series:** operates without a bag, nor a filter and automatically empties itself into the drain by electrodes.
- ✓ Vacuums both dry and liquid substances.
- ✓ Equipped with a membrane, a porthole and two water jets.
- ✓ Requires a water supply.

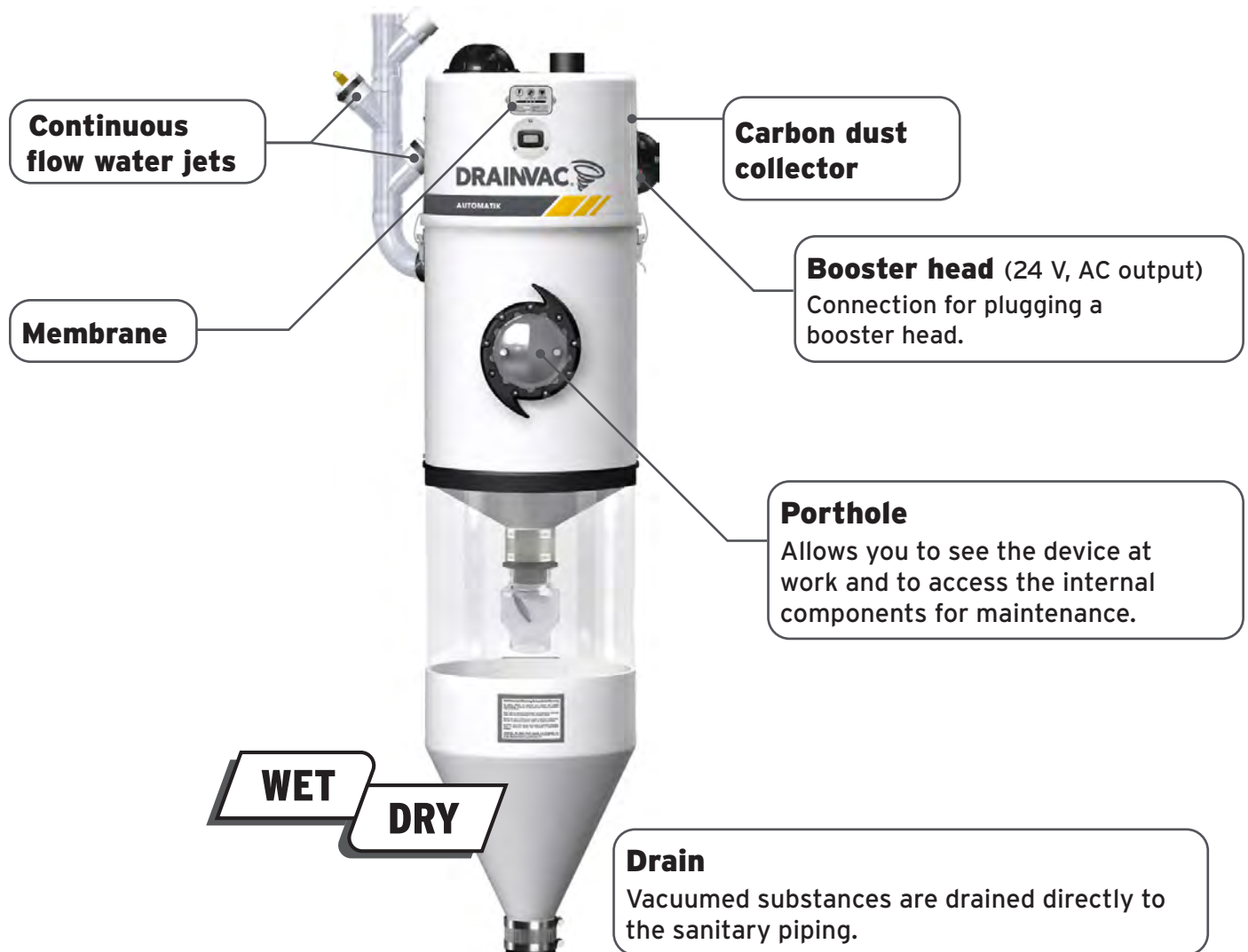

AUTOMATIK

Operation sequence:

Watch the video sequence!

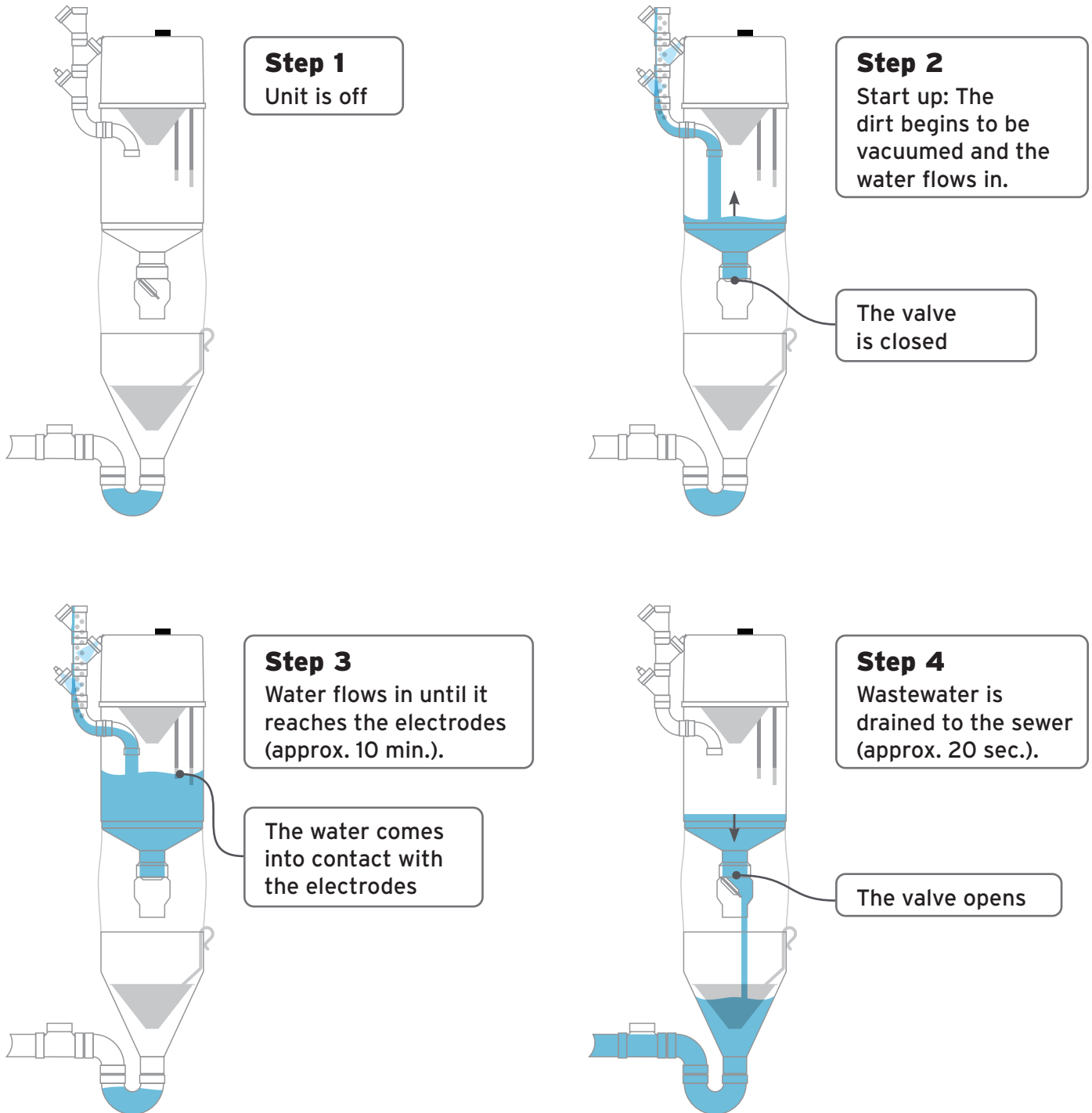

AUTOMATIK

Operation sequence:

TEST

The first LED will light up when the device is plugged in, indicating that there is power. By pressing the TEST button, the device starts up. Press a second time to turn off the device. In case of troubleshooting, this button allows you to check the status of the device independently of the 24 V electrical network.

RESET

The middle light turns on after 500 hours of usage. This reminds you that maintenance is required and that the unit should be inspected by a Drainvac retailer. Maintenance should only be reset by a Drainvac technician.

FLUSHING TIME

Press once to initiate a short drain
LED flashes once

Press twice quickly to initiate an average drain
LED flashes twice

Press three times quickly to initiate a long drain
LED flashes three times

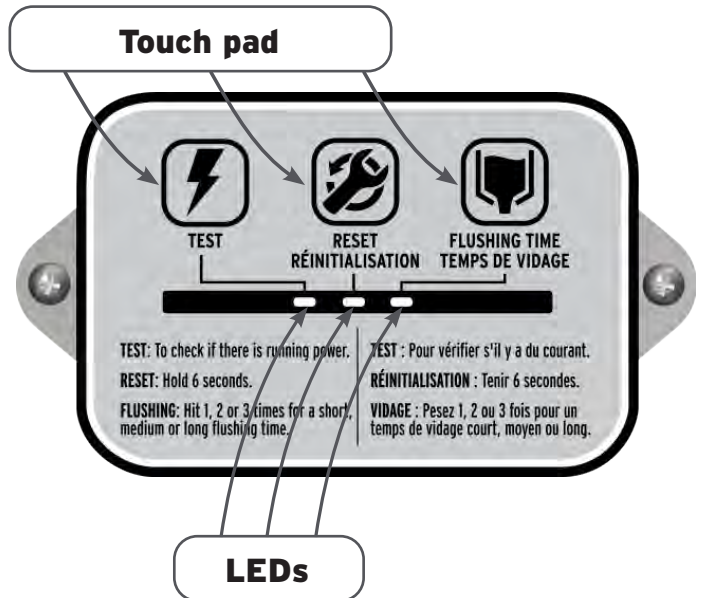

BOOSTER

Specific characteristics of this series:

- ✓ Increases the power of a unit.
- ✓ Can be connected to increase flow rate or water column.

Caution:

- ✓ Maximum of 2 Boosters per unit
- ✓ Can only be connected to commercial units.*
***Certain commercial models do not have the option to connect to an auxiliary head.**



A booster head can be installed in two ways; either in series or in parallel.

A configuration in series
produces more water column.

A configuration in parallel
produces more CFM..



BOOSTER

MODEL	TETE05
POWER	3.46 HP
WATERLIFT	4191 mmH ₂ O
AIRFLOW	198 m ₃ /h
NOISE LEVEL	70 dB
VOLTAGE	220V - 240V
WATTS	2592
HEIGHT	30 cm
DIAMETER	38 cm
WEIGHT	15.9 kg
FUSE	12 A
ELECTRICAL PANEL	16 A circuit breaker

MOTOR	MOTE14
TYPE	Bypass
QUANTITY	2 en série
DIAMETER	14 cm
AMPS	10,8
CARBON BRUSHES	BROS28



- ✓ Includes 1 muffler
- ✓ Compatible with models :
DF1R19-CT, DF1R20-CT, DF2A31-CB et DF2A33-CB



All illustrations, specifications, colors and photographs shown may vary. The power values may vary. These are calculated according to the voltage used in the factory and in accordance to the supplier's technicalities. While Drainvac takes care to ensure that the information contained in this publication is accurate, it cannot guarantee complete accuracy. Drainvac is not responsible for errors or omissions contained in this publication.